

GLYNN VIVIAN

Children's  
Activity  
Pack

Glynn Vivian Art Gallery

Alexandra Road

Swansea SA1 5DZ



@glynnvivian

01792 516900

[glynnvivian.co.uk](http://glynnvivian.co.uk)

Welcome to your very own  
Glynn Vivian Children's  
Activity Pack!

Here we have do-it-yourself  
art activities to help you  
explore each room in the  
gallery. But the fun doesn't  
stop there.

When you've finished looking  
around, collect our Glynn  
Vivian Children's Extension  
Pack to keep on creating  
at home.

Use the QR codes to watch  
short video demonstrations  
And send your creations to us  
on social media!

# Garden Room

Here's a strange question...

Spring is in the air and flowers are popping up everywhere

But what would you look like as a flower?

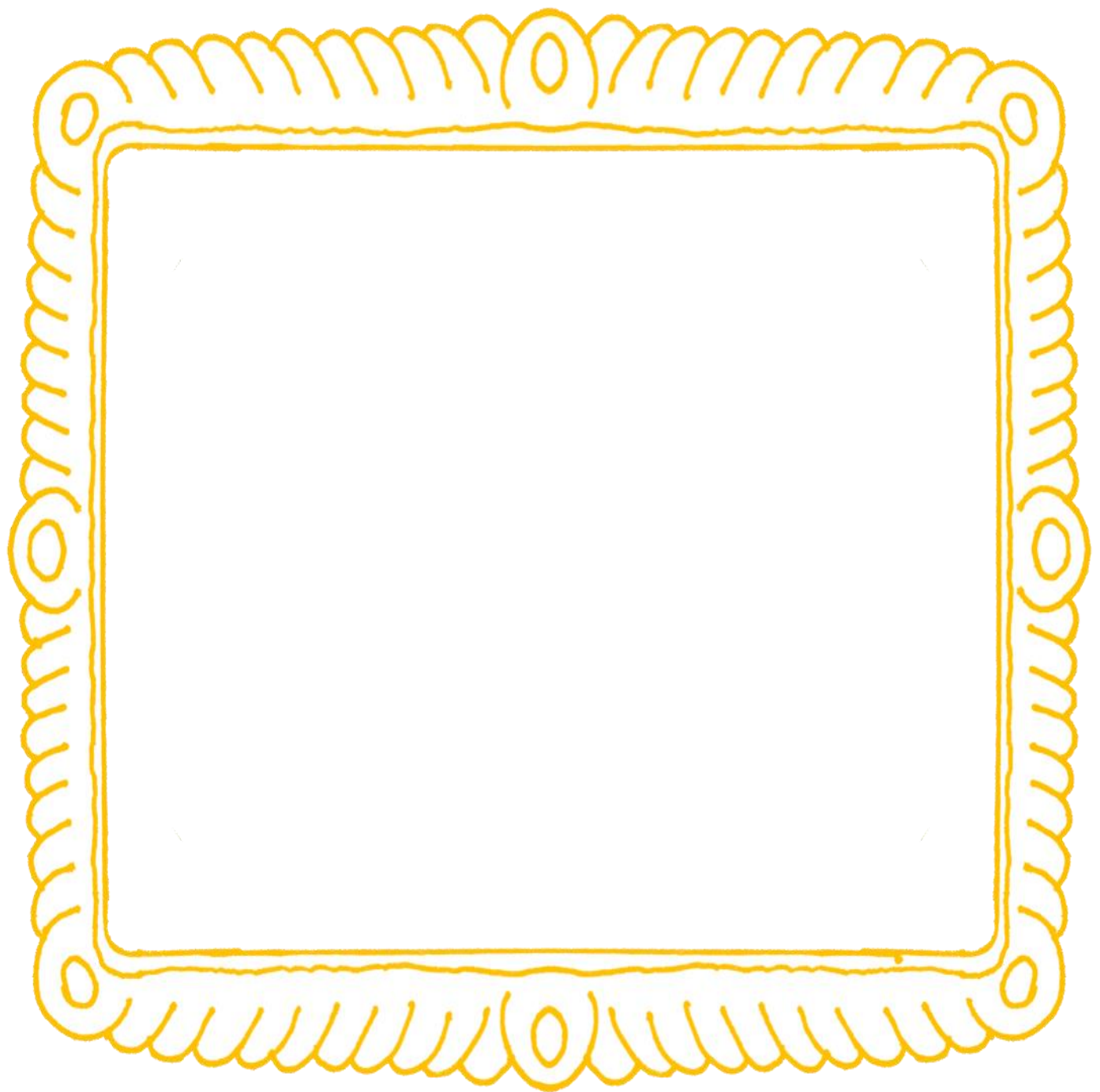

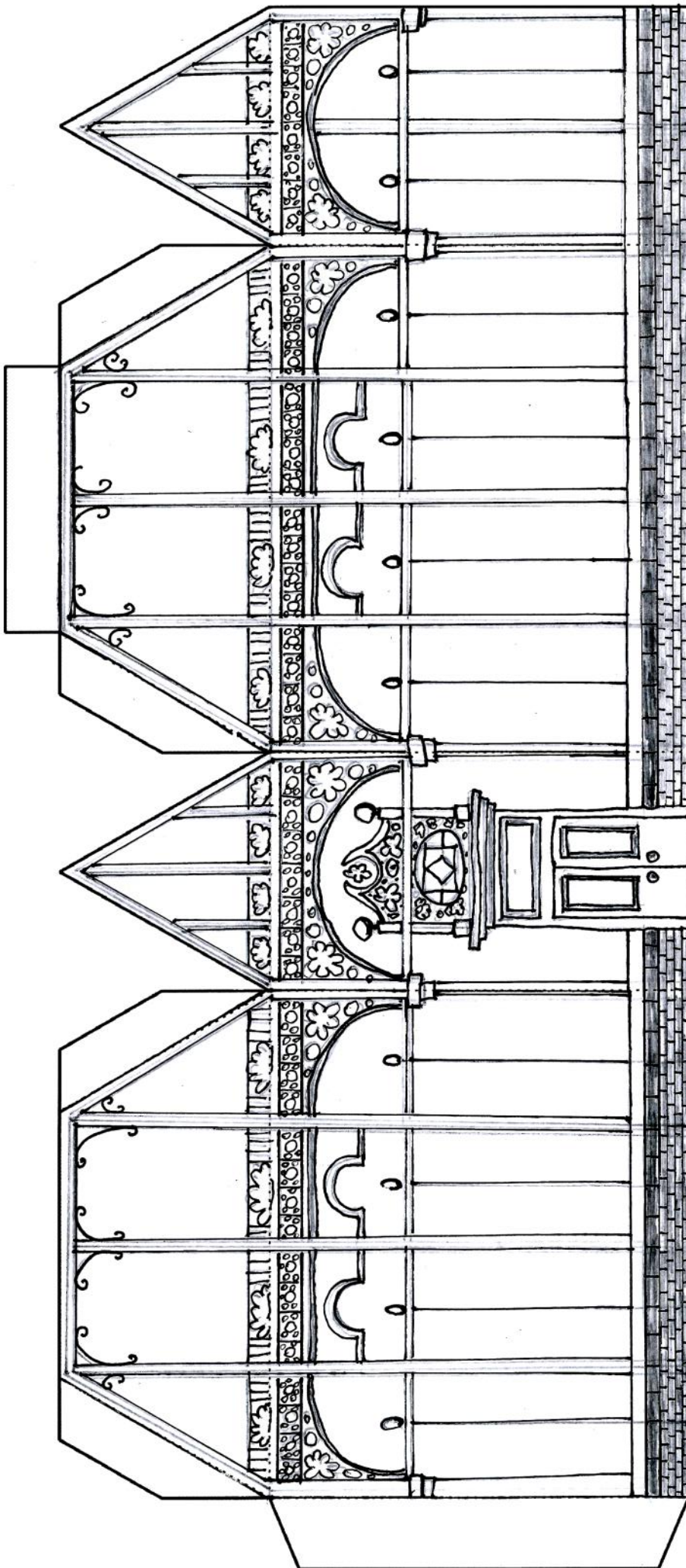

# Atrium

In this room we have nature inspired artwork from the gallery's art collection.

Your quest is to draw some of these plants into this glasshouse.

Colour, cutout and glue your glasshouse to make it 3-D!

## **Fun fact:**

Did you know you are currently surrounded by dinosaurs?

The marble circles on the floor have fossilized ammonites in them.

How many can you find?





# Mezzanine

A collection is a group of things or people. At the Gallery, we look after a collection of over 10,000 artworks! Here are two portraits from our collection but someone has rubbed out their faces! Can you repair them before anyone notices?



*Mervyn Levy , Alfred Janes, Oil on canvas, 1935*





*Portrait of a Young Woman,*

Evan Walters,

1929, oil on canvas.



# Room 4

This art gallery was built by Richard Glynn Vivian. He was a wealthy Victorian who owned a local copper works.

For owners like Glynn Vivian, copper brought great wealth and freedom. But it was a tough life for people working in the factories with hard work and low pay.

Imagine the tables are turned and Richard Glynn Vivian is having a hard day: What do you think his cook will serve him for dinner to try to cheer him up?



Can you draw your favourite thing from Room 4?

# Room 5

There are a lot of postcards in this room. They were made by people from all over Swansea during lockdown.

Use this template to design and write a postcard to somebody you haven't seen for a while.

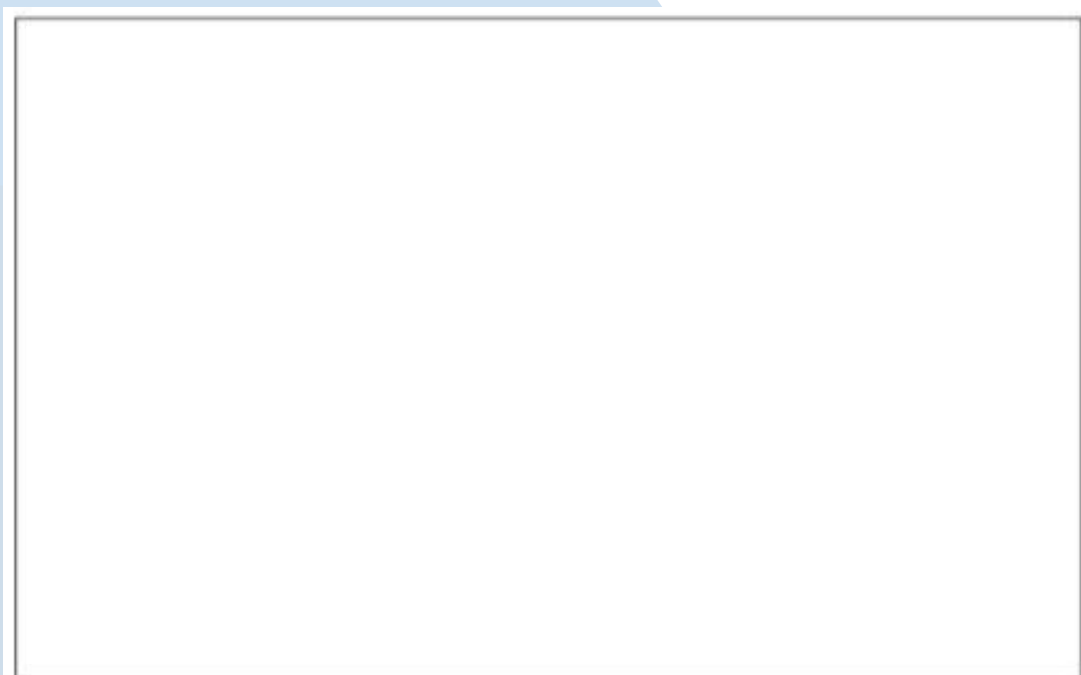



*Don't Forget* to use the correct address  
and to stick a stamp on  
before you send it!

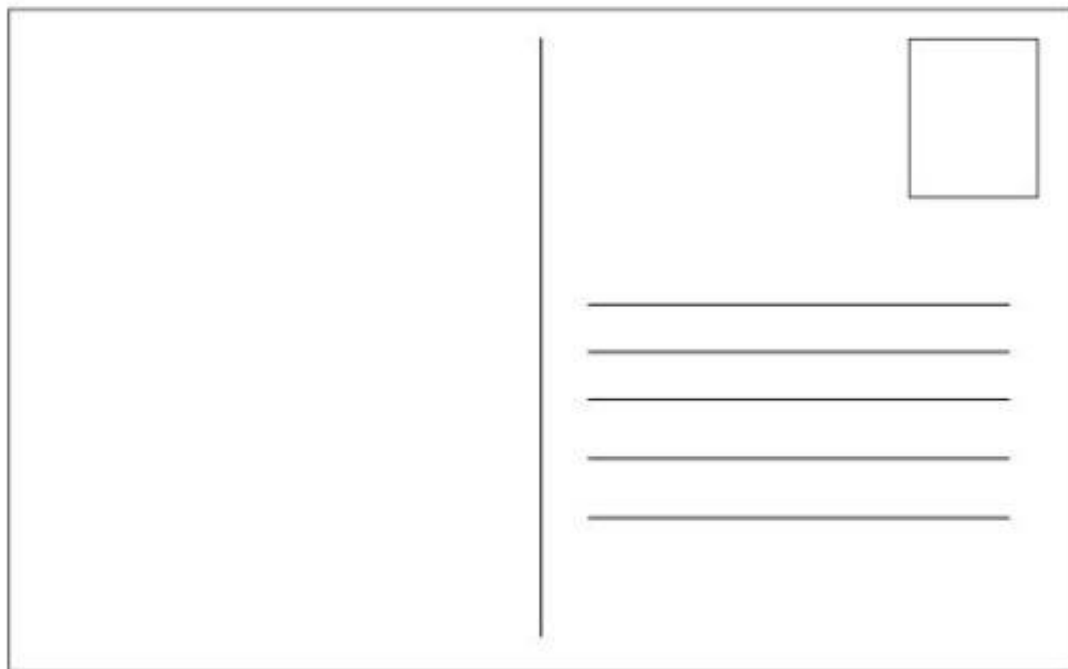

A diagram of a postcard layout. It is a large rectangle divided by a vertical line. The left side is a large empty space. The right side contains a small rectangular box in the top right corner and five horizontal lines below it, intended for an address.

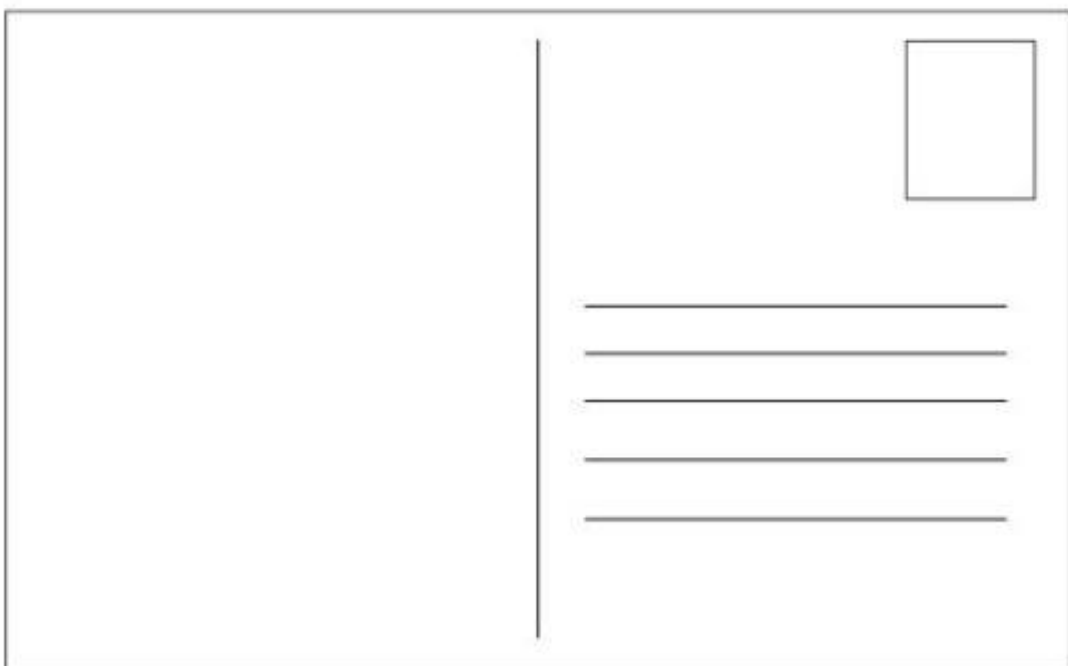

A diagram of a postcard layout, identical to the one above. It is a large rectangle divided by a vertical line. The left side is a large empty space. The right side contains a small rectangular box in the top right corner and five horizontal lines below it, intended for an address.

# Room 6

Wow! Look at this great waterfall.  
Now seems like a good time to take a rest.

Lie down in front of the waterfall and look up at it.  
Can you hear the water crashing off the rocks?

Can you create a poem about water?  
Here is a famous poem by Japanese poet Boshō

Old pond  
frogs jumped in  
sound of water

# Water

A Poem by .....

.....

.....

.....

Can you draw a picture of Water to go  
alongside your Poem?



# Room 7

Anya Paintsil makes these amazing-looking pictures using a technique called rug-hooking. Each mark is a piece of wool pulled through the canvas. Anya also uses real hair in her pictures! Have you ever thought of that?

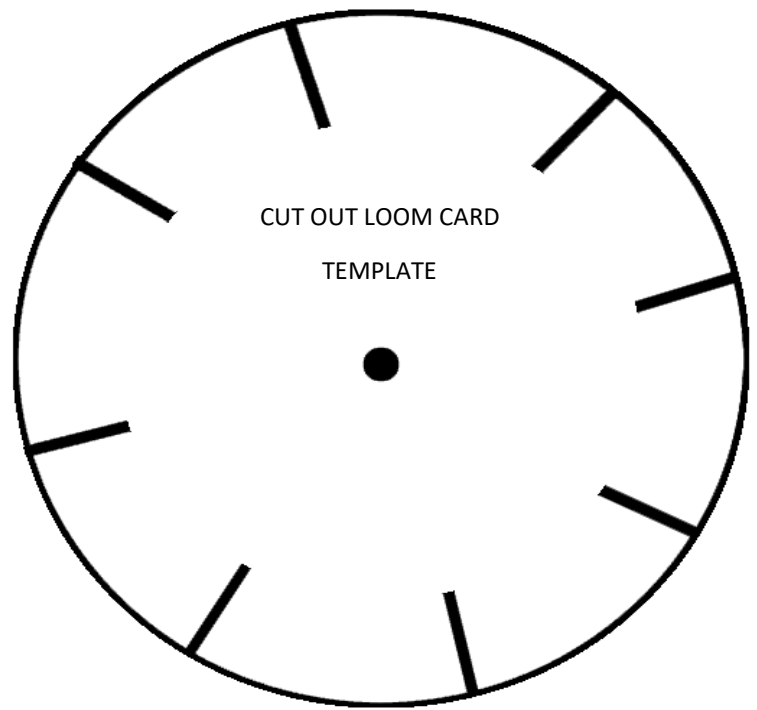

Braid your own friendship bracelet using the instructions, threads and card loom provided:

Watch our demonstration on YouTube by scanning this QR code. Materials available from the front desk.



1. Cut out your loom template along the lines.
2. Make a hole in the centre (and adult can help you with this)
3. Tie the 7 threads together at one end

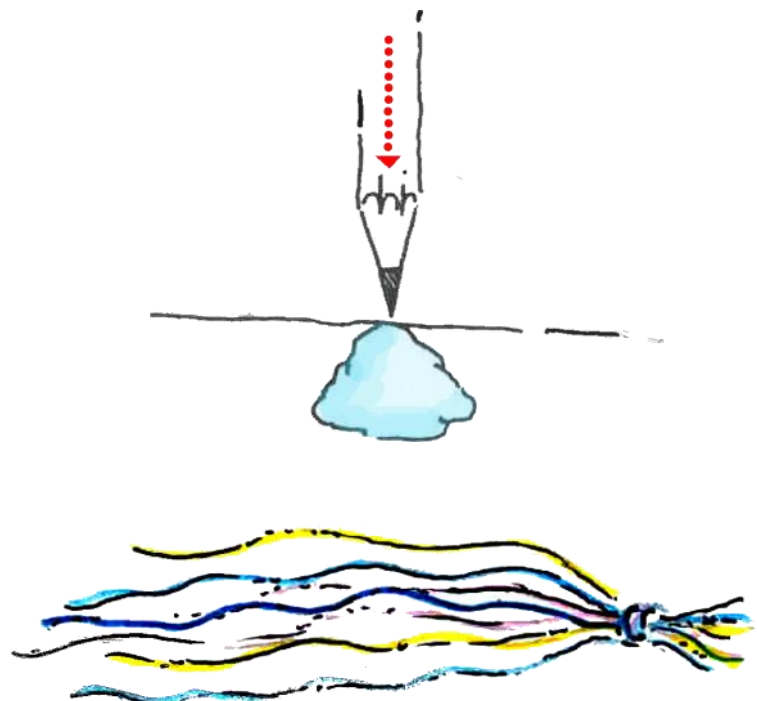

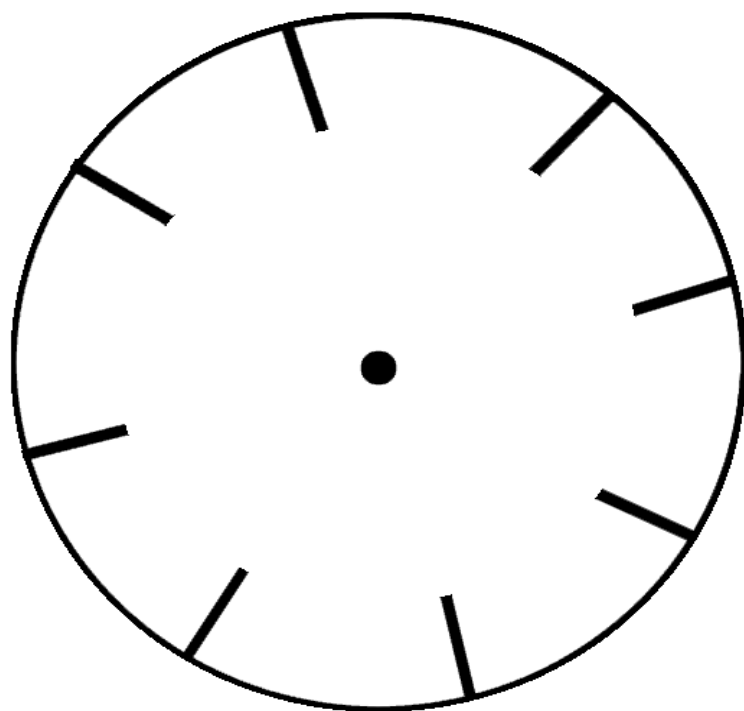

4. Feed the other end through the hole in your loom

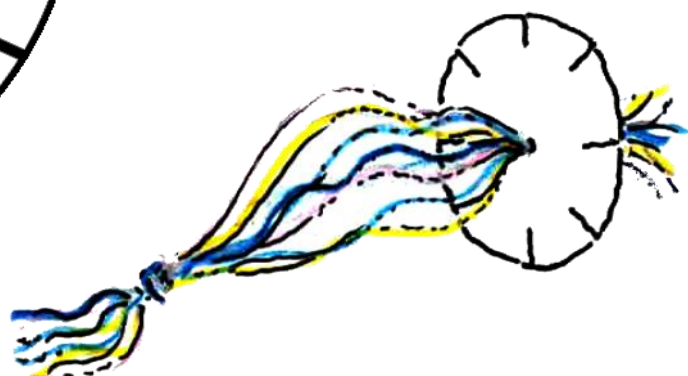

5. Slot each thread into a slot on the edge of your loom. There should be one slot left over

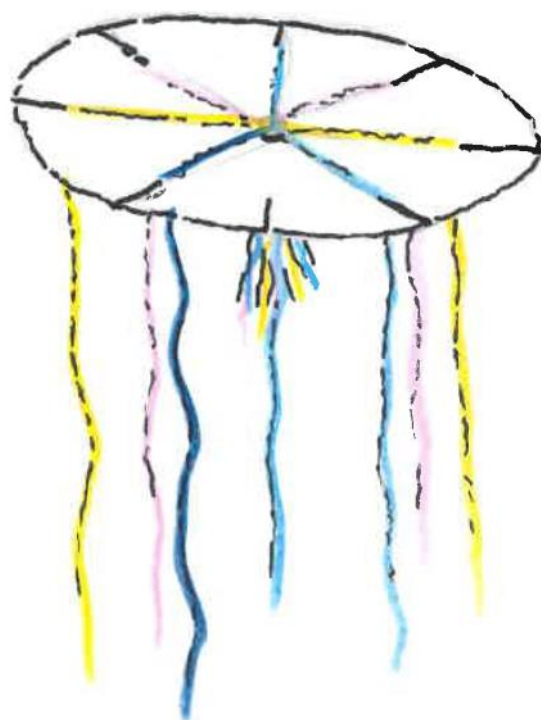
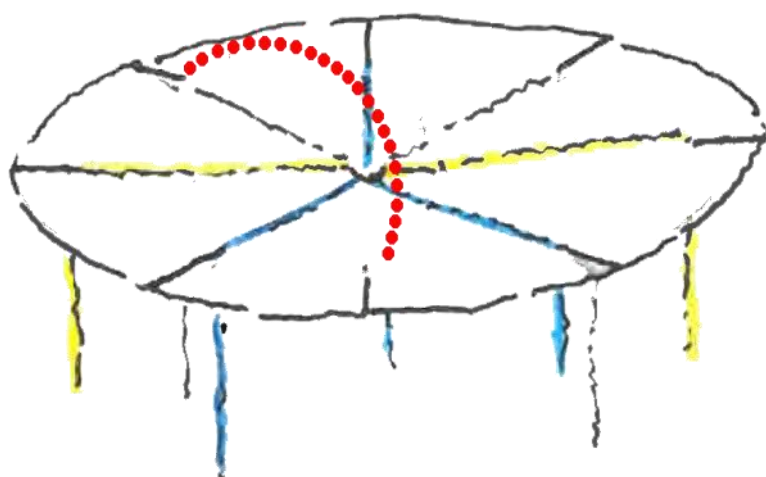

6. From the empty slot, take the 3<sup>rd</sup> thread to the left and slot it into the empty slot

Repeat this process using the 3<sup>rd</sup> slot to the left of your empty slots.

This should mean you start to turn the loom as you work. Every now and then give the not on the bottom of the loom a tug to keep the tension tight.

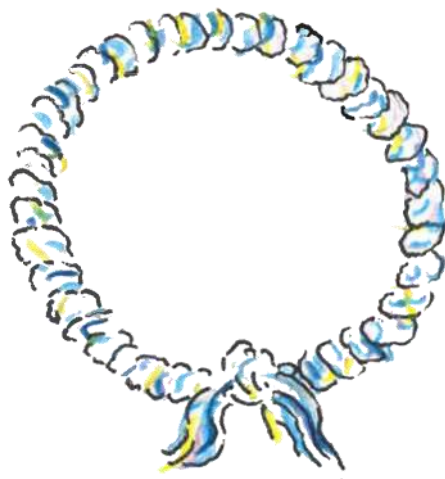
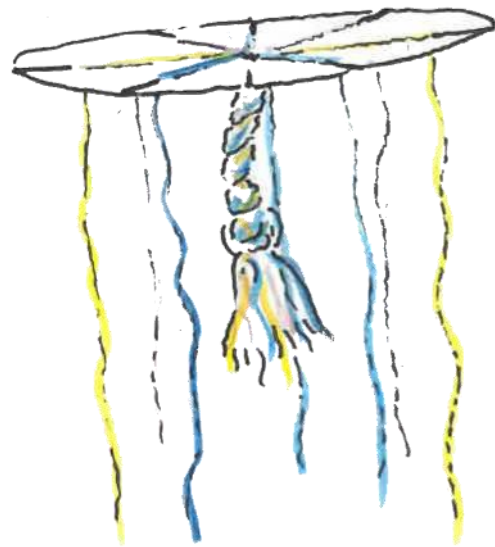

When you are happy that your bracelet is long enough you can tie each end together.

When you're done, give it to a friend!

Tips: You can change the order you braid to make different patterns or ask different friends to choose a thread each.



# Room 8

Watch our short tutorial on making a clay moon using the materials provided at reception when you leave



In this exhibition the artist Dafydd Williams has made lots of tiny photos of Jupiter and it's moons to go alongside the pictures of himself and his partner at home.

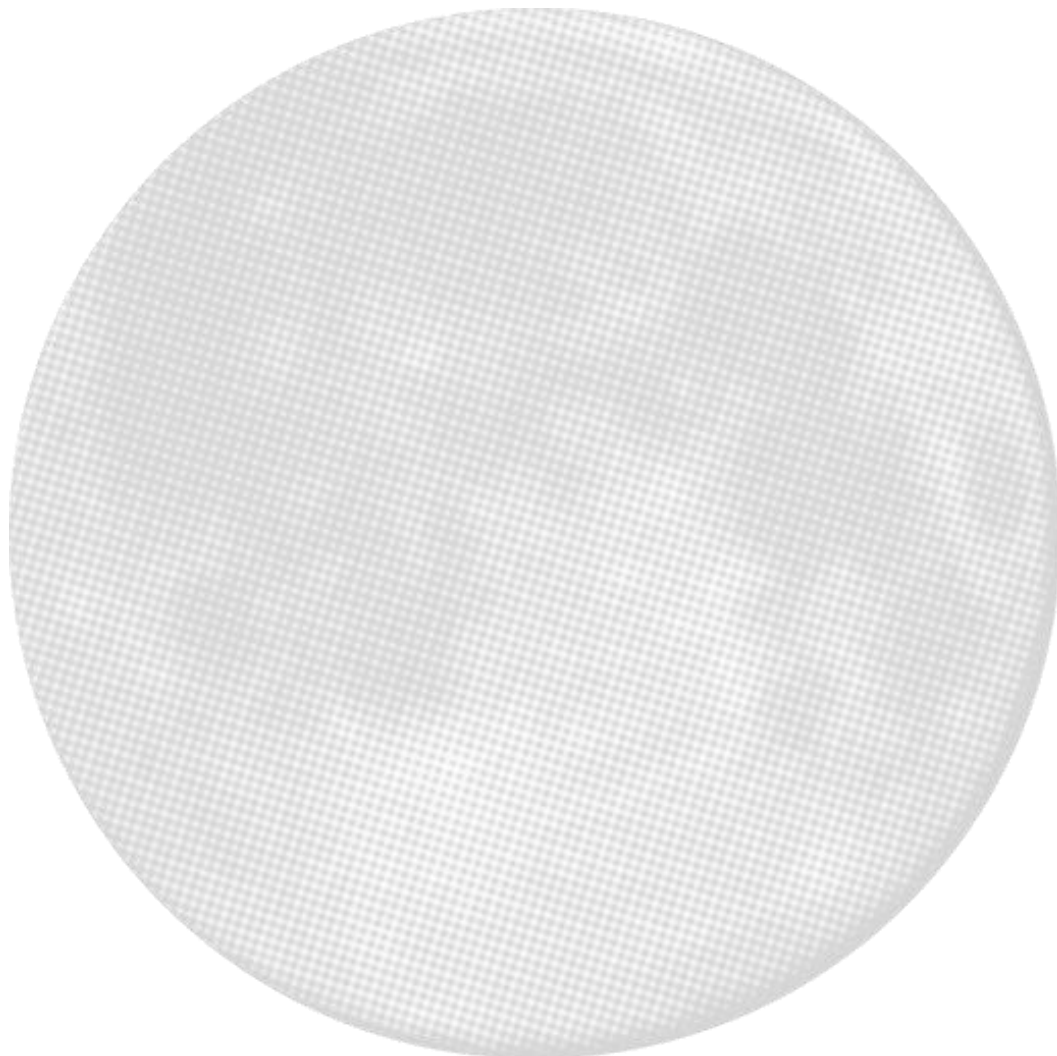

Colour this circle and give it a name

My Moon is called .....

...this moon orbits you.

# Room 9

In Kathryn Ashill's video "Fools Gold", we see an imaginary mine, and even the room itself has been made to look like one!

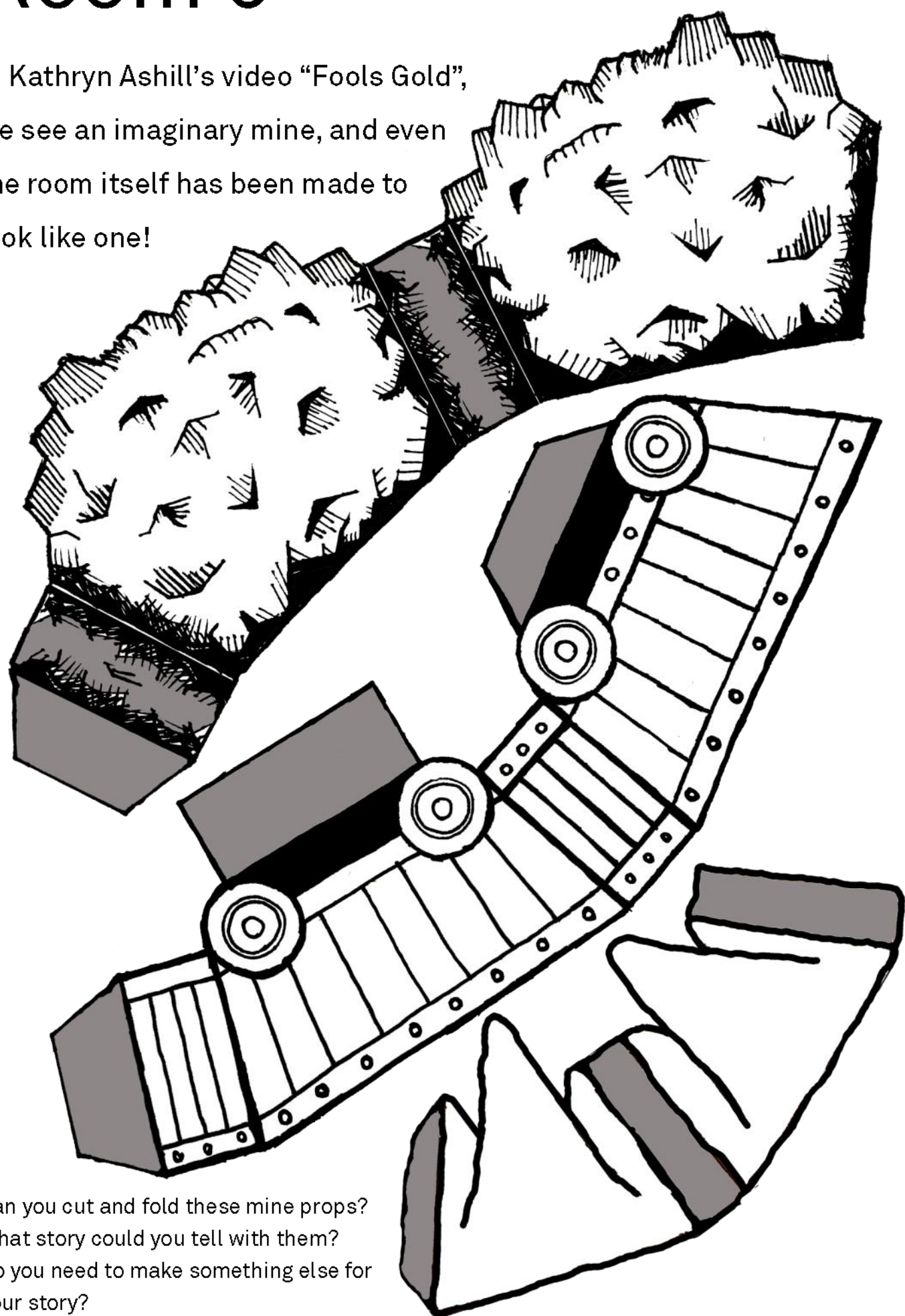

Can you cut and fold these mine props?  
What story could you tell with them?  
Do you need to make something else for  
your story?

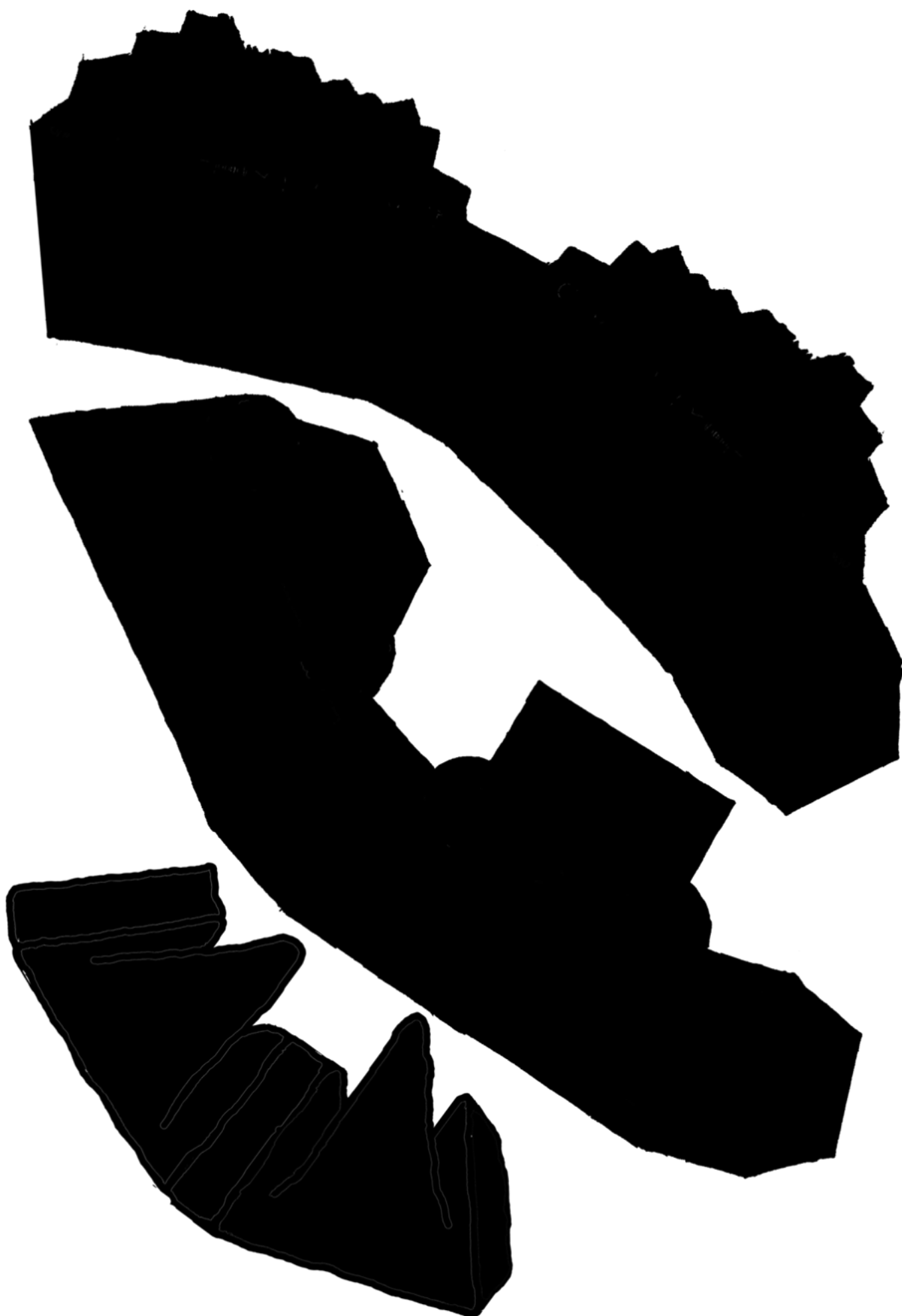



When you've finished at the gallery get your passport stamped on your way out. Collect 6 stamps to earn your first Glynn Vivian Explorers badge. There are 3 to collect. And don't forget to collect your Extension Pack to carry on creating at home.

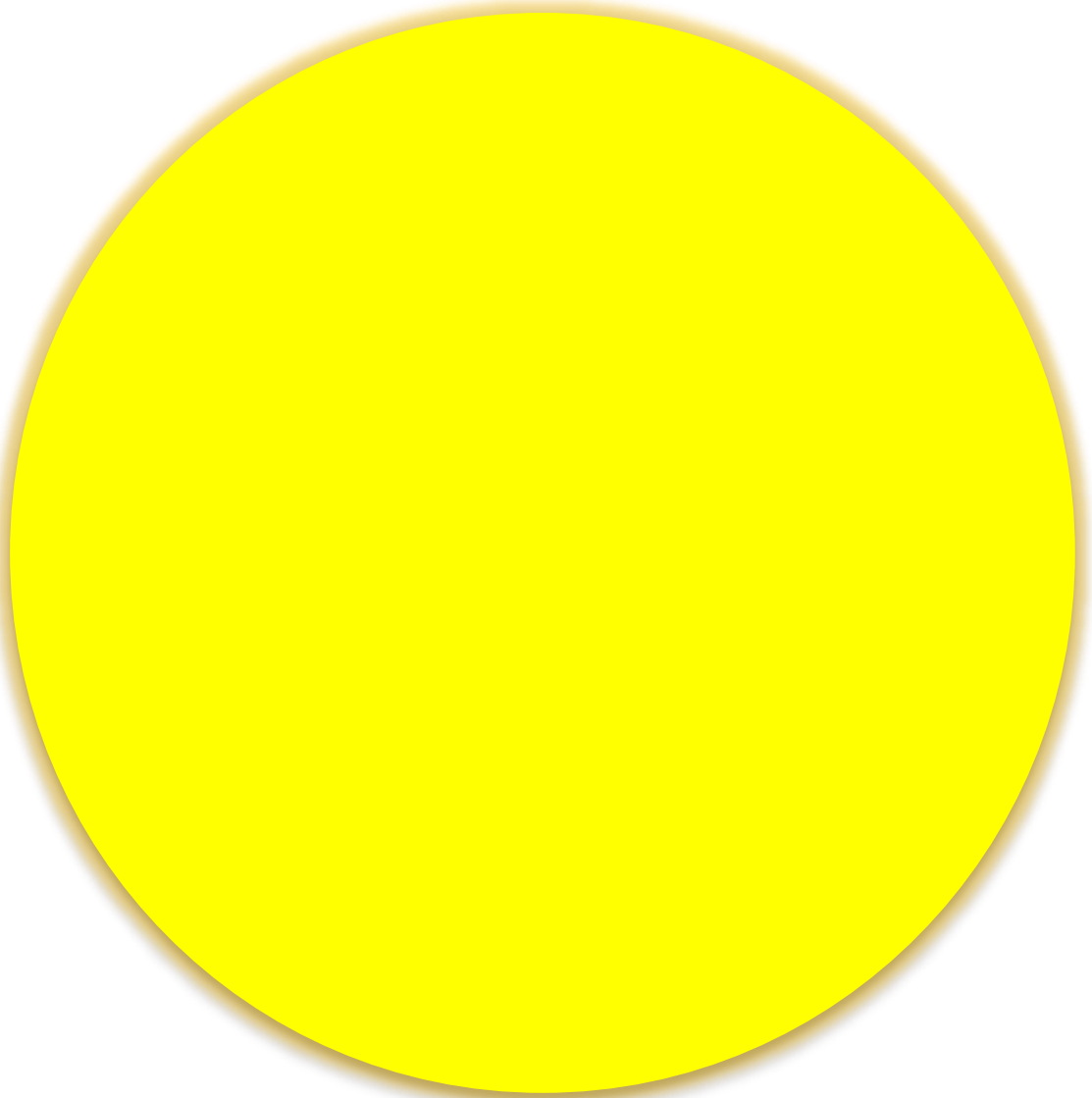

One last thing—Draw how you feel about our activity book in this yellow circle. And send your feedback to us so we can keep improving!



@glynnvivian

## What I'm going to do next:

[illegible][illegible]

.....

[illegible][illegible]

.....

.....

.....

[illegible][illegible][illegible]

\_\_\_\_\_

\_\_\_\_\_



